



CAMRY HYBRID

2 0 1 7



QUICK REFERENCE GUIDE



2017

CAMRY HYBRID

This Quick Reference Guide is a summary of basic vehicle operations. It contains brief descriptions of fundamental operations so you can locate and use the vehicle's main equipment quickly and easily.

The Quick Reference Guide is not intended as a substitute for the Owner's Manual located in your vehicle's glove box. We strongly encourage you to review the Owner's Manual and supplementary manuals so you will have a better understanding of your vehicle's capabilities and limitations.

Your dealership and the entire staff of Toyota Motor Sales, U.S.A., Inc. wish you many years of satisfied driving in your new Camry Hybrid.

A word about safe vehicle operations

This Quick Reference Guide is not a full description of Camry Hybrid operations. Every Camry Hybrid owner should review the Owner's Manual that accompanies this vehicle.

Pay special attention to the boxed information highlighted in color throughout the Owner's Manual. Each box contains safe operating instructions to help you avoid injury or equipment malfunction.

All information in this Quick Reference Guide is current at the time of printing. Toyota reserves the right to make changes at any time without notice.

OVERVIEW

Engine maintenance	8
Fuel tank door release and cap	7
Hood release	8
Indicator symbols	4-5
Instrument cluster	4
Instrument panel	2-3
Keyless entry ^{1,2}	6
Light control-Instrument panel	8
Smart Key system ^{1,2}	7

FEATURES & OPERATIONS

Air conditioning/heating	19
Audio	21
Auto lock/unlock ^{1,2}	10
Blind Spot Monitor (BSM)	18
Bottle holders/Cup holders	20
Clock	19
Cruise control	16
Dynamic Radar Cruise Control (DRCC)	17
Garage door opener (HomeLink®) ³	16
Hybrid Synergy Drive System	9
Lane Departure Alert (LDA)	24
Lights ¹ & turn signals	15
Moon roof	12
Multi-Information Display (MID) ¹	23
Parking brake	11
Power outlets-12V DC	14
Pre-Collision System (PCS)	23
Rear view monitor system	18
Seat adjustments-Front	13
Seat adjustments-Rear	13
Seat heaters	20
Seats-Head restraints	12
Steering lock release	10
Steering wheel controls (Audio & telephone Bluetooth®)	22

FEATURES & OPERATIONS (continued)

Tilt and telescopic steering wheel	11
Transmission	10
USB/AUX port	14
Windows - Power	11
Windshield wipers & washers	14
Wireless charging	20

SAFETY & EMERGENCY FEATURES

Door locks	25
Doors-Child safety locks	25
Floor mat installation	29
Safety Connect	26
Seat belts	25
Seat belts-Shoulder belt anchor	26
Spare tire & tools	27
Star Safety System™	28-29
Trunk internal release	27

BLUETOOTH® DEVICE PAIRING SECTION

30-39

¹ Visit your Toyota dealer for information on customizing this feature.

² Programmable by customer. Refer to the Owner's Manual for instructions and more information.

³ HomeLink® is a registered trademark of Gentex Corporation.

Instrument panel

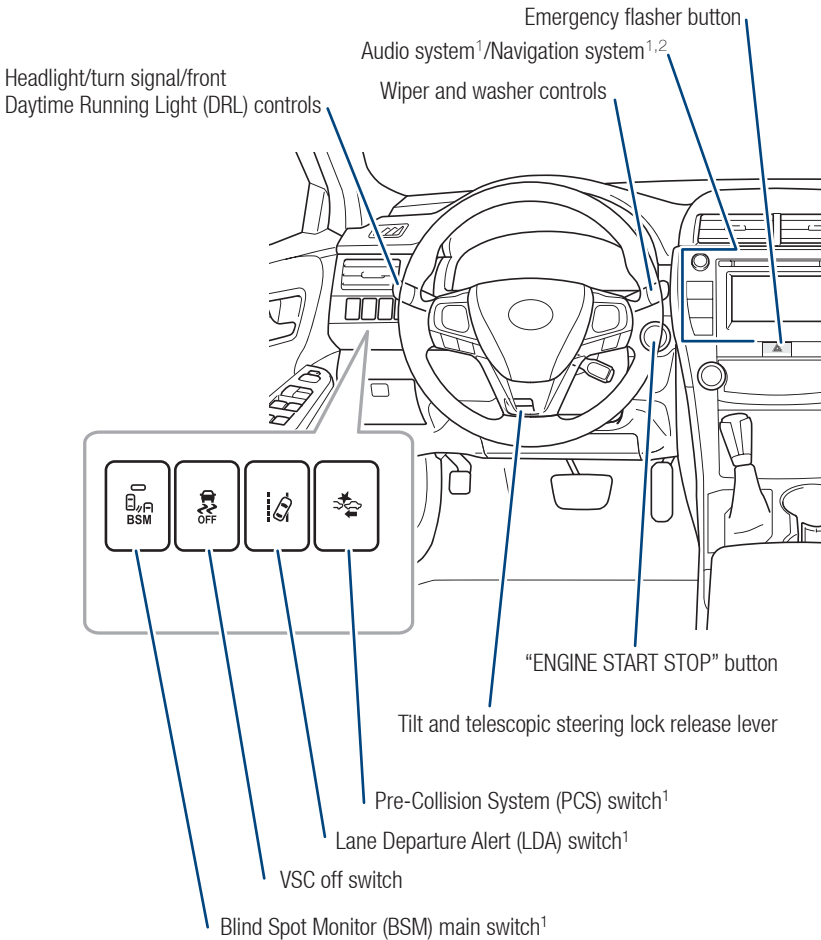
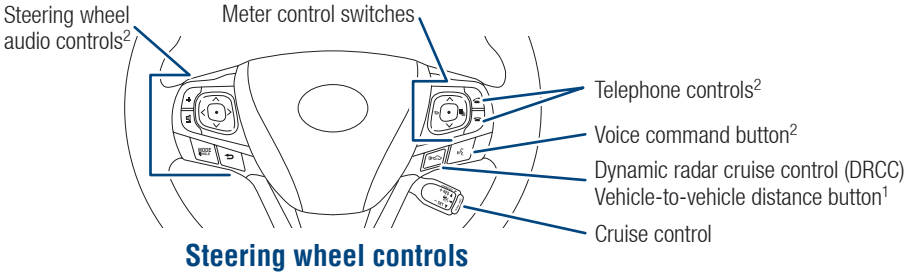

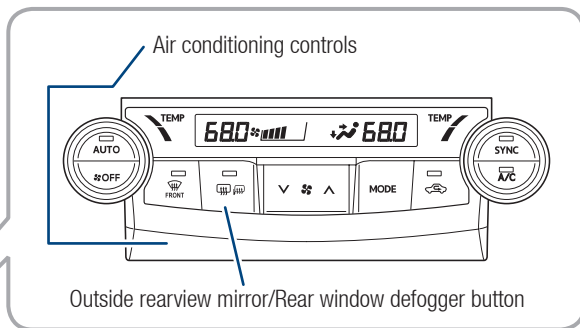

Tire Pressure Monitoring (warning) System (TPMS) reset switch¹

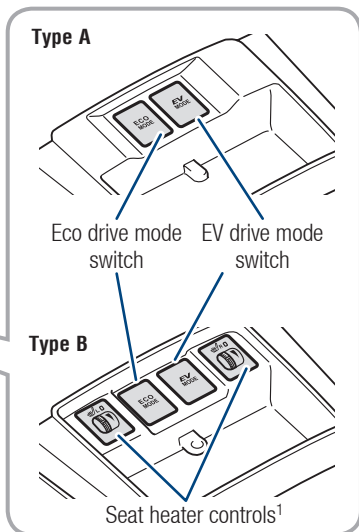

¹ If equipped.

² For vehicles with Entune Premium Audio or Entune Audio Plus, refer to the "Navigation System Owner's Manual" and "2017 Entune™ Audio Quick Reference Guide."

OVERVIEW

Instrument cluster

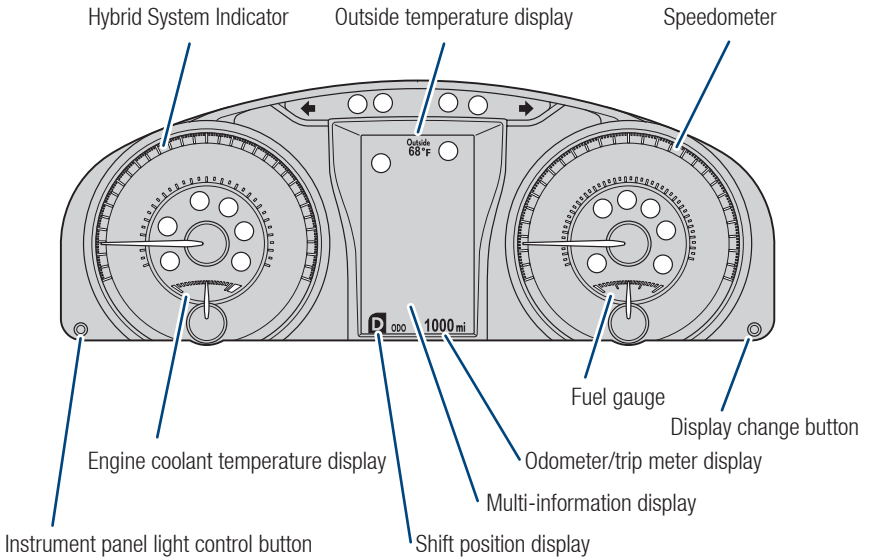

○ Service indicators and reminders

Indicator symbols

For details, refer to "Indicators and warning lights," Section 2-2, 2017 Owner's Manual.

BRAKE Brake system warning¹

 Driver seat belt reminder and/
or front passenger seat belt reminder
(alarm will sound if speed is over 12 mph)

ABS Anti-lock Brake System warning¹

 Malfunction/
Check Engine indicator¹

 Brake system warning

 Master warning¹

READY READY indicator

¹ If indicator does not turn off within a few seconds of starting the Hybrid System, there may be a malfunction. Have vehicle inspected by your Toyota dealer.

² If this light flashes, refer to "Cruise control," Section 4-5, 2017 Owner's Manual.



Passenger Air Bag ON/OFF indicator¹



Airbag SRS warning¹



Low Tire Pressure Warning^{1,4}



Electric power steering system warning¹



Theft deterrent/ Engine Immobilizer system indicator



Fuel tank door position



Low fuel level warning



Low outside temperature indicator



Lane Departure Alert (LDA) indicator⁴



Pre-Collision System (PCS) warning light^{1,4}



Slip indicator¹



Vehicle Stability Control OFF indicator¹



Headlight low/high beam indicators



Automatic High Beam indicator⁴



Turn signal indicator



EV indicator



EV drive mode indicator



ECO MODE indicator



SET



Cruise control indicators^{2,3}

³ Light flashes in yellow to indicate a malfunction. Light flashes quickly in green to indicate that the steering lock has not been released.

⁴ If equipped.

OVERVIEW

Keyless entry (and remote entry)

LOCKING OPERATION

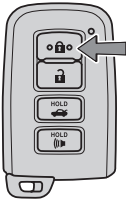

Push

Carry remote Type C
Smart key feature

All-door lock

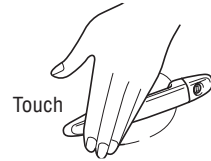

Touch

UNLOCKING OPERATION

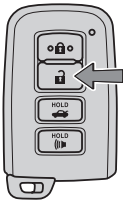

Push

ONCE: Driver door
TWICE: All doors

Carry remote Type C
Smart key feature

Driver door unlock*

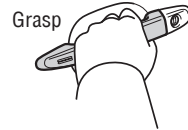

Grasp

NOTE: If a door is not opened within 60 seconds of unlocking, all doors will relock for safety.

TRUNK LID

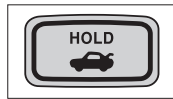
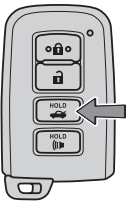

Push and hold

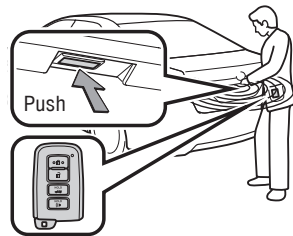

Push

PANIC BUTTON

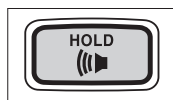

Push and hold



Smart key system

START FUNCTION

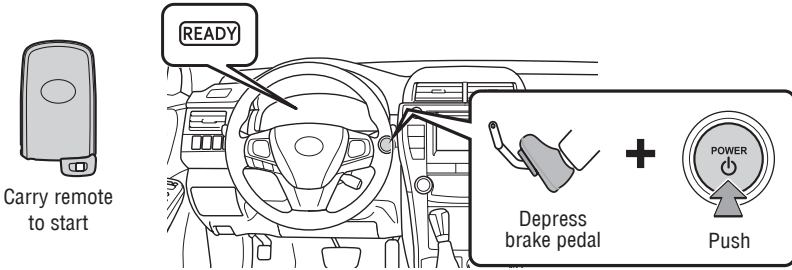

NOTE: Gear shift lever must be in Park and brake pedal depressed.

POWER (WITHOUT STARTING HYBRID SYSTEM)

Without depressing the brake pedal, pressing the "POWER" button will change the operation mode in succession from:

ACCESSORY	Accessories such as the audio will operate.
ON	Power ON; all electrical systems can be used.
OFF	All systems OFF; emergency flashers can be used.

Fuel tank door release and cap

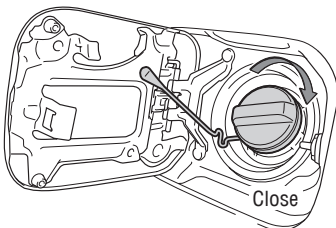
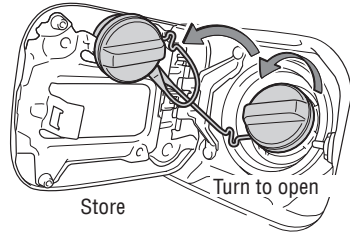
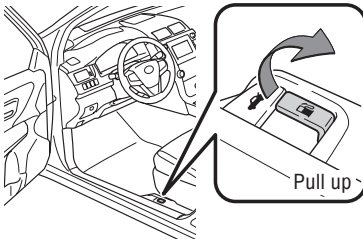

NOTE: Tighten until one click is heard. If the cap is not tightened enough, Check Engine "CHECK" indicator may illuminate.

OVERVIEW

Hood release

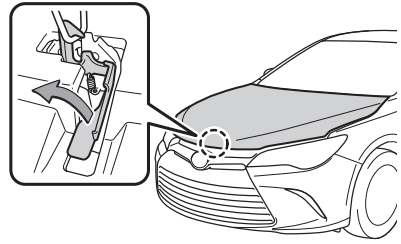
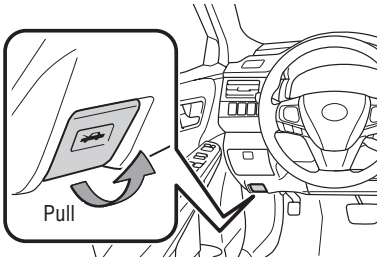

Pull up latch and raise hood

Engine maintenance

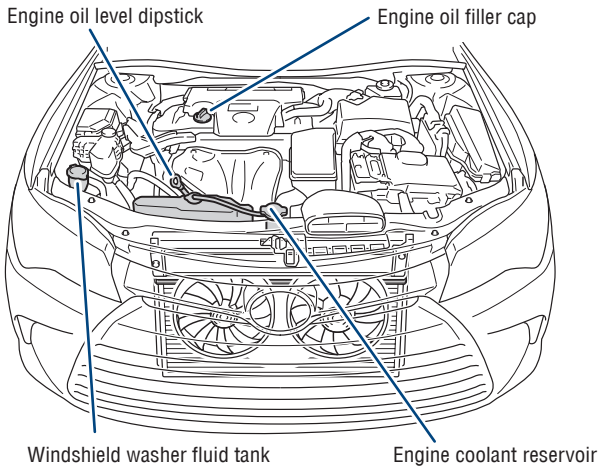

NOTE: Regularly scheduled maintenance, including oil changes, will help extend the life of your vehicle and maintain performance. *Please refer to the "Warranty Maintenance Guide."*

Light control-Instrument panel

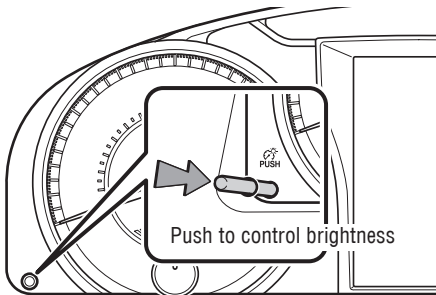

FEATURES AND OPERATIONS

Hybrid Synergy Drive System

The Hybrid Synergy Drive System utilizes a computer-controlled gasoline engine and electric motor to provide the most efficient combination of power for the vehicle. To conserve energy, when the brakes are applied the braking force generates electricity which is then sent to the traction battery. In addition, the engine shuts off when the vehicle is stopped. The benefits are better fuel economy, reduced vehicle emissions and improved performance.

NOTE: Fuel consumption and energy information of the Hybrid System are shown on the Entune™ Audio system screen or the navigation system.

TIPS FOR IMPROVED FUEL ECONOMY

- Ensure tire pressures are maintained at levels specified in the Owner's Manual.
- When possible, link trips to reduce engine cold starts.
- Avoid driving at speeds that are higher than necessary, especially on the highway.
- When possible, avoid sudden stops to maximize regenerative braking energy.
- Minimize use of the air conditioning.

STARTING YOUR VEHICLE

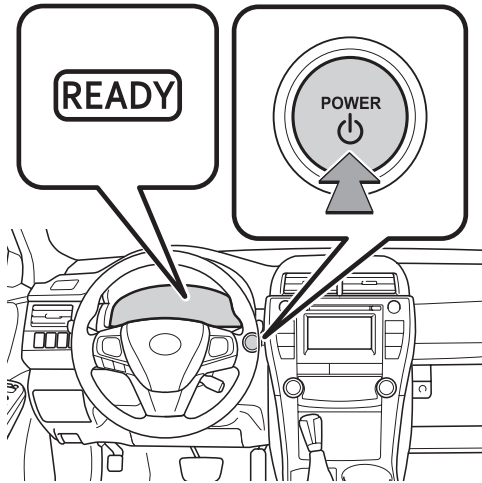

1. Put the selector lever in "P."
2. Depress the brake pedal, and "P" will be displayed on the Multi-Information Display (MID).
3. Press the "POWER" switch briefly and firmly.
4. The "READY" light will blink. After a few seconds, when the light remains steady and a beep sounds, you may begin driving.

FEATURES AND OPERATIONS

Auto lock/unlock

Automatic door locks can be programmed to operate in two different modes, or turned OFF.

- Doors lock when shifting from Park.
- Doors lock when the vehicle speed is approximately 12 mph or higher.
- Doors unlock when shifting into Park.
- Doors unlock when the driver's door is opened within 10 seconds after turning the "POWER" switch OFF.

Refer to the Owner's Manual for more details.

Transmission

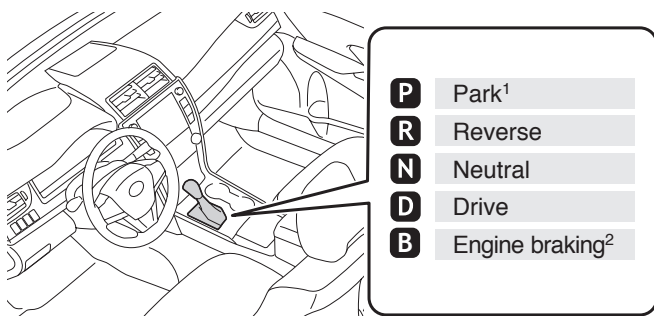

¹ The "POWER" switch must be set at "ON" and the brake pedal depressed to shift from Park.

² The engine brake is the equivalent of downshifting. Shift to "B" when engine braking is desired (i.e. downhill driving, coasting to a stop, etc.).

Steering lock release

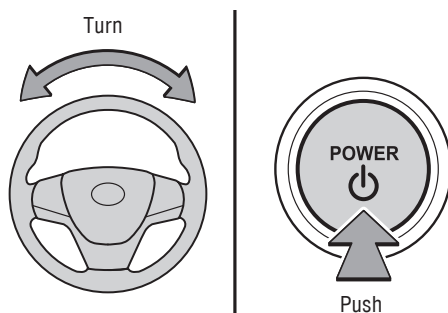

Tilt and telescopic steering wheel

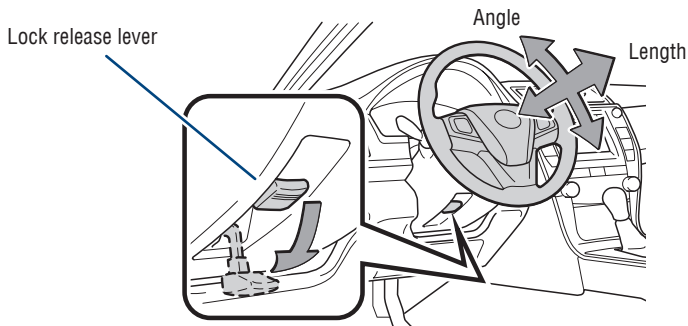

Hold wheel, push lever down, set angle and length, and **return lever**.

NOTE: Do not attempt to adjust while the vehicle is in motion.

Parking brake

BRAKE

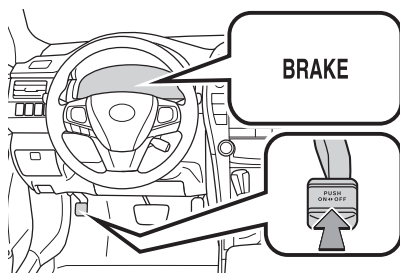

Set: Depress
Release: Depress again

Windows - Power

Driver side

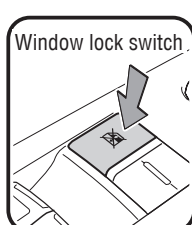
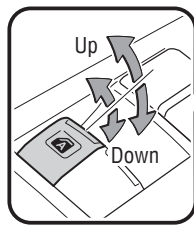

Automatic operation Push the switch completely down or pull it completely up and release to fully open or close. To stop the window partway, operate the switch in the opposite direction.

Window lock switch Deactivates all passenger windows. Driver's window remains operable.

FEATURES AND OPERATIONS

Moon roof (if equipped)

SLIDING OPERATION

Push once to open partway; again to open completely.

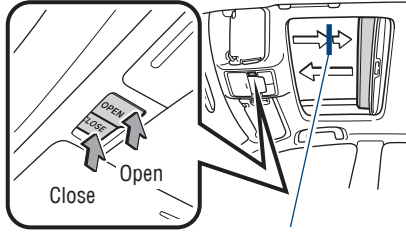

Recommended driving position to minimize wind noise.

TILTING OPERATION

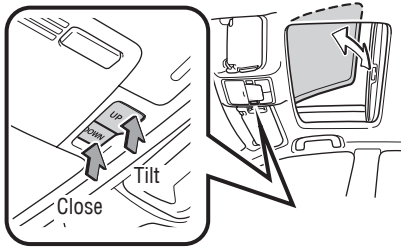

Push once to open; moon roof will automatically stop at the recommended position. Push again to open completely.

Seats - Head restraints

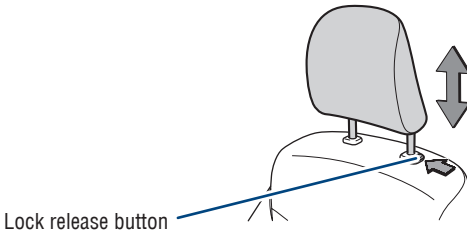

Seat adjustments - Front

MANUAL SEAT

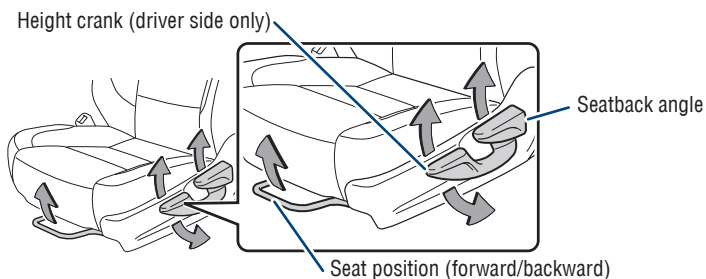

POWER SEAT (IF EQUIPPED)

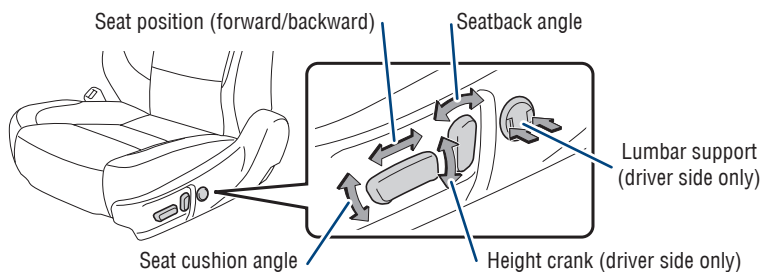

Seat adjustments-Rear

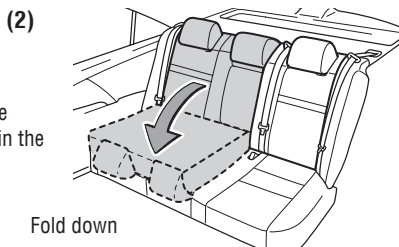
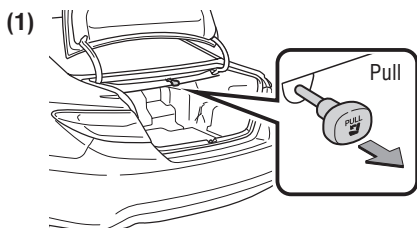

Tip: To fold rear seats, the release button is located in the trunk.

Refer to the Owner's Manual for more details.

FEATURES AND OPERATIONS

Windshield wipers & washers

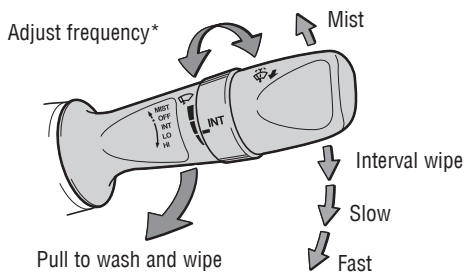

* **Intermittent windshield wiper frequency adjustment** Rotate to increase/decrease wipe frequency.

Power outlets-12V DC

Front console

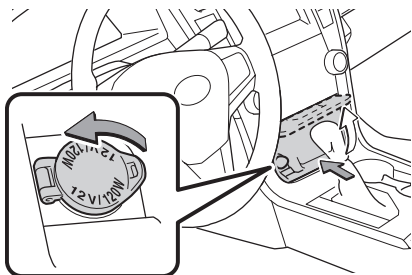

Center console

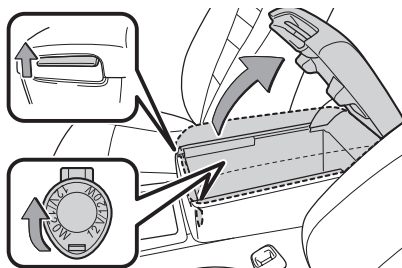

The "POWER" switch/ignition switch must be set at "ACCESSORY" or "ON" position for use.

USB/AUX port

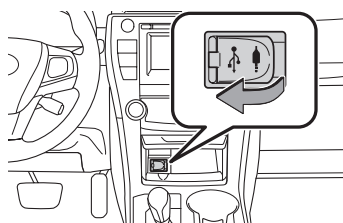
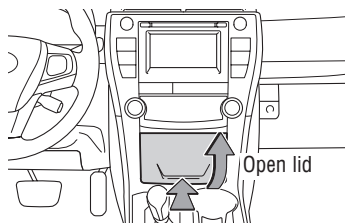

By connecting a USB-compatible portable audio device or USB memory to the USB port, you can listen to music from the portable audio device or USB memory through the vehicle's speaker system.

By inserting a mini plug into the AUX port, you can listen to music from a portable audio device through the vehicle's speaker system while in AUX mode.

Lights & turn signals

HEADLIGHTS

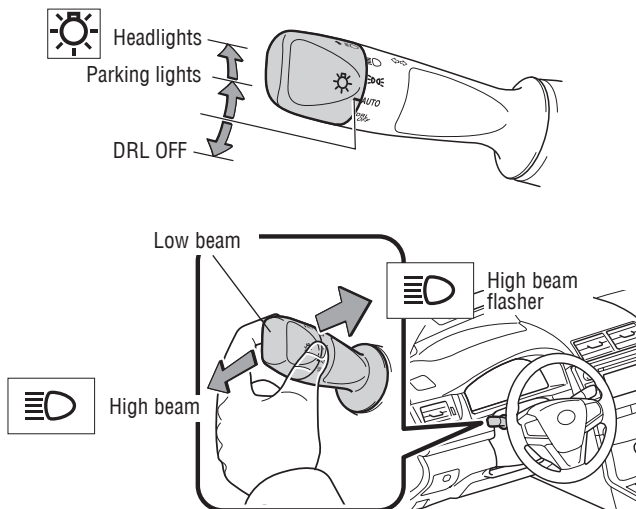

-Daytime Running Light system (DRL) Automatically turns on the headlights at a reduced intensity.

-Automatic light cut off system Automatically turns lights off after 30-second delay, or lock switch on remote may be pushed after locking.

TURN SIGNALS

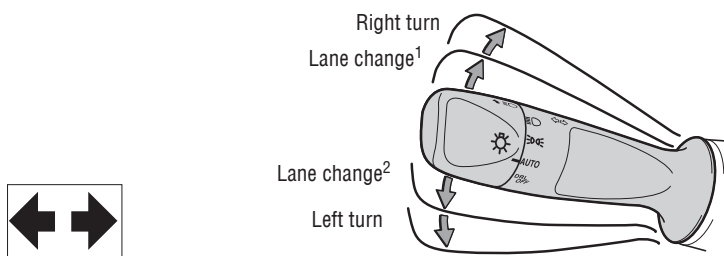

¹ The right hand signals will flash three times.

² The left hand signals will flash three times.

FEATURES AND OPERATIONS

Garage door opener (HomeLink®*)(if equipped)

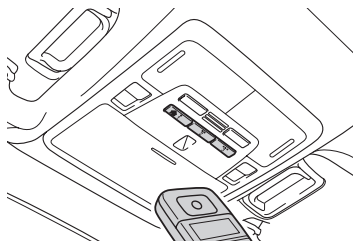

Garage door openers manufactured under license from HomeLink®* can be programmed to operate garage doors, estate gates, security lighting, etc.

Refer to "Garage door opener," Section 6-4 in the Owner's Manual for more details.

For programming assistance, contact HomeLink® at 1-800-355-3515, or visit <http://www.homelink.com>.

* HomeLink® is a registered trademark of Johnson Controls, Inc.

Cruise control

TURNING SYSTEM ON/OFF

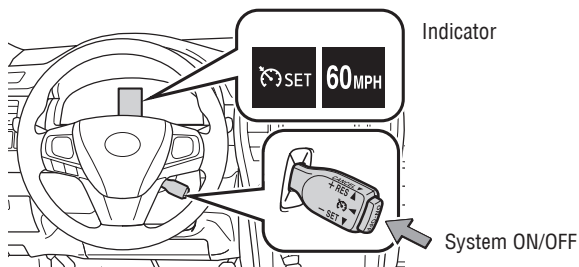

FUNCTIONS

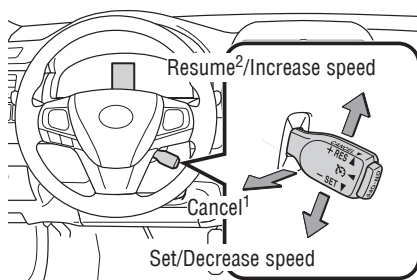

¹ The set speed may also be cancelled by depressing the brake pedal.

² The set speed may be resumed once vehicle speed exceeds 25 mph.

Dynamic Radar Cruise Control (DRCC)(if equipped)

Refer to the Owner's Manual for more details and complete safety precautions before attempting to use "Dynamic Radar Cruise Control."

FIXED SPEED MODE

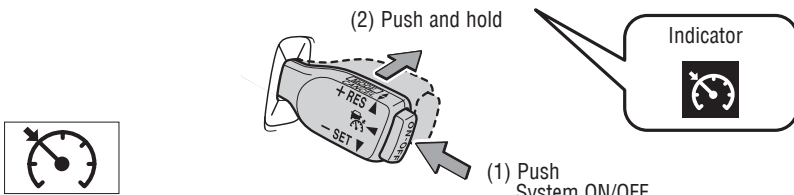

To set, cancel and resume a speed Refer to "Summary of Functions" in the Cruise Control section, and to the Owner's Manual for more details.

DISTANCE CONTROL MODE

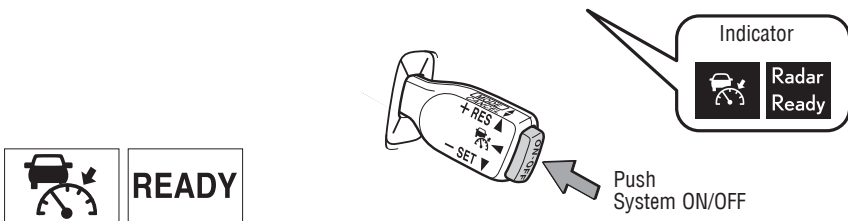

The distance control mode will cruise at a set speed, decelerate to maintain a selected distance from a slower vehicle traveling in front of you, and accelerate back up to the selected speed if the vehicle in front changes lanes or speeds up.

To set, cancel and resume a speed Refer to "Summary of Functions" in the Cruise Control section, and your Owner's Manual for more details.

NOTE: Once vehicle speed is set, pushing lever up toward "+ RES" will increase speed to the nearest 5 mph, and then in 5 mph increments. Pushing lever down toward "- SET" will reduce speed in the same way.

VEHICLE-TO-VEHICLE DISTANCE

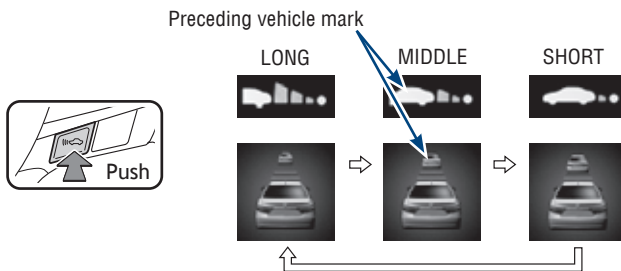

To change the vehicle-to-vehicle distance

Push the distance button to cycle through the settings, which will change progressively from LONG to MIDDLE to SHORT.

FEATURES AND OPERATIONS

Blind Spot Monitor (BSM) (if equipped)

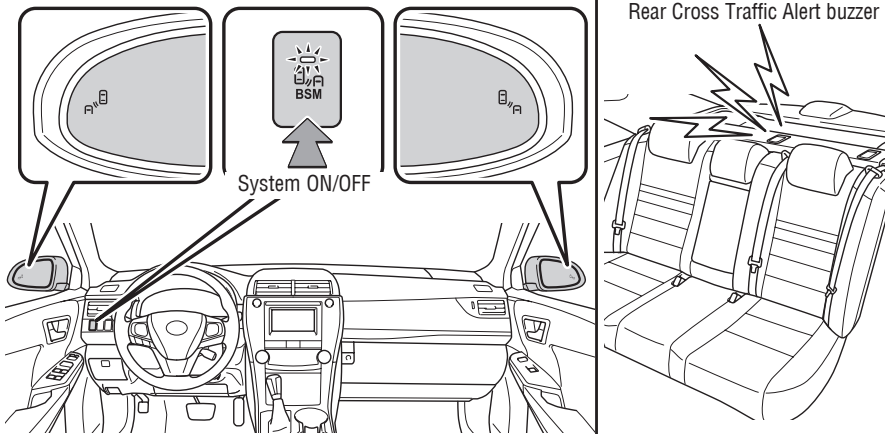

The Blind Spot Monitor is a system that has two functions:

- The Blind Spot Monitor function (assists the driver in decision-making when changing lanes)
- The Rear Cross Traffic Alert function (assists the driver when backing up)

The Blind Spot Monitor function uses radar sensors to detect vehicles that are traveling in an adjacent lane in the area that is not reflected in the outside rear view mirror (the blind spot), and advises the driver of the vehicles existence via the outside rear view mirror indicator.

Refer to the Owner's Manual for limitations and more details on this system before attempting to use it.

Rear view monitor system

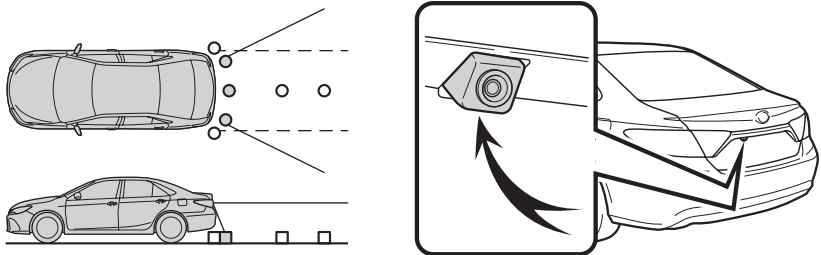

The rear view monitor system displays an image of the view from the bumper of the rear area of the vehicle. The camera for the rear view monitor system is located above the license plate.

To adjust the image on the rear view monitor screen, press the "SETUP" button and select "Display" on the "Setup" screen. Select "Camera" to adjust the screen contrast and brightness.

Refer to the Owner's Manual for limitations and more details on this system.

Clock

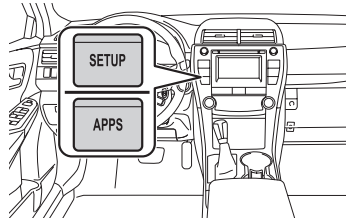

To find your system, refer to Audio section of this guide.

For Entune™ Audio

Push **“SETUP”** button next to the screen

then select **“General”** in the touch screen to access clock setting.

For Entune™ Audio Plus and Entune™ Premium Audio

Push **“APPS”** button next to the screen

then select **“General”** in the touch screen to access clock setting.

Air conditioning/heating

Automatic Air Conditioning

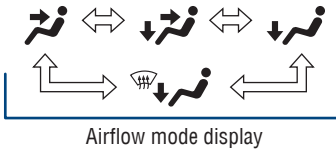

“SYNC” button - Indicator ON: Synchronized temperature settings for driver and passengers. Indicator OFF: Separate temperature settings for driver and passengers.

Automatic climate control ON - Adjusting the temperature setting will cause the airflow vents, air intake and fan to adjust automatically.

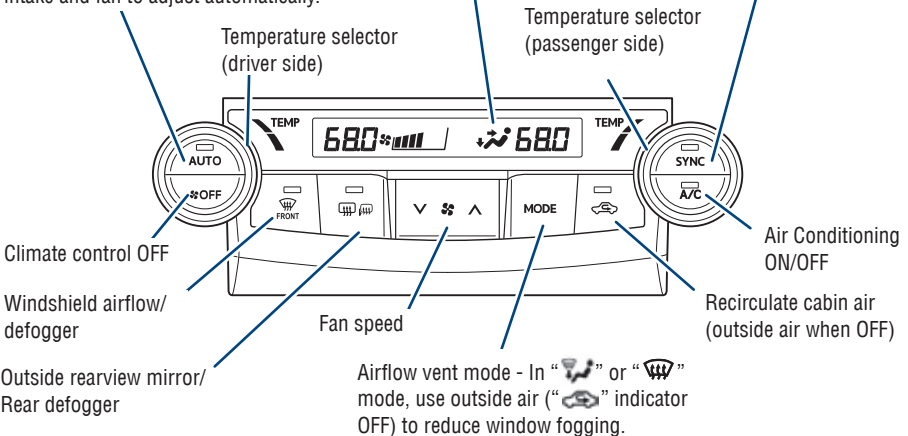

FEATURES AND OPERATIONS

Seat heaters (if equipped)

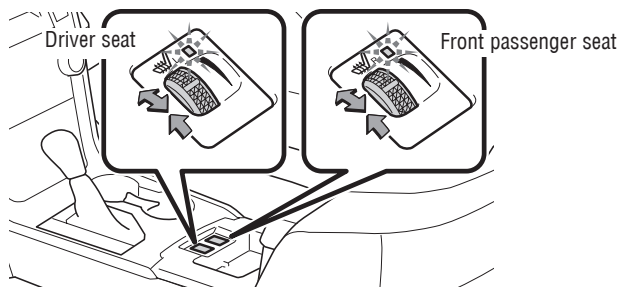

Bottle holders/Cup holders

Front

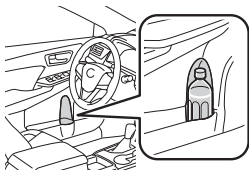
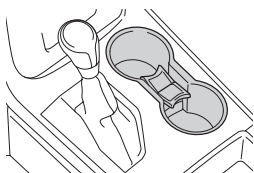

Rear

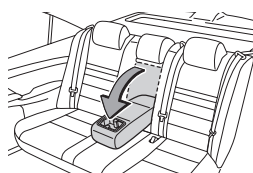

Wireless Charging (if equipped)

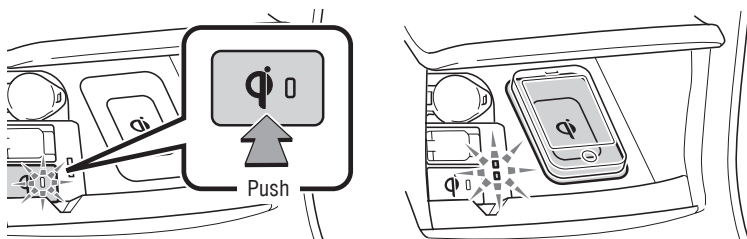

A mobile device can be charged wirelessly on the tray. Open the lid and press the wireless charger switch. Place a mobile device on the tray as shown in the illustration. An amber indicator is illuminated while charging is in progress. When charging is complete, a green indicator will also be illuminated. Some phones, cases or cover type wireless chargers may not cause the green indicator to illuminate even though it is fully charged.

Refer to the Owner's Manual for more details on this system before attempting to use it.

Audio (if equipped)

Entune™ Audio

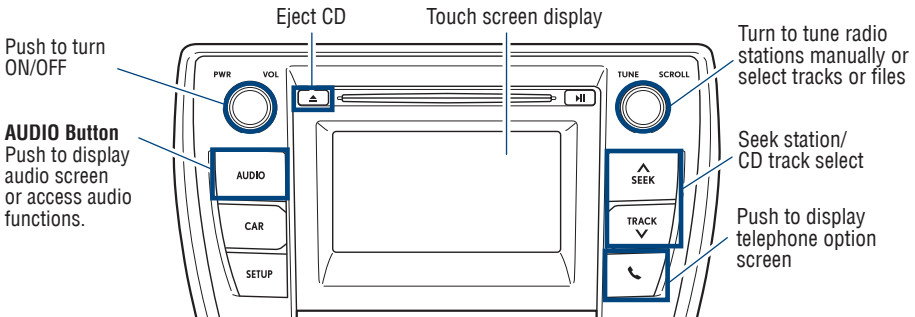

Entune™ Audio Plus With Connected Navigation App (JBL® Audio)

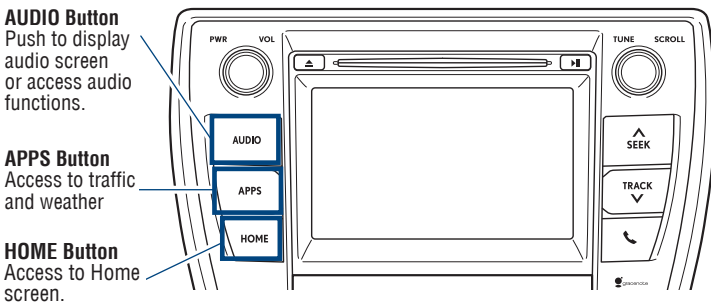

HOME SCREEN - The home screen offers a two and three panel layout. Information and layout will vary depending on selected set up.

Entune™ Premium (JBL®) Audio with Integrated Navigation and App Suite

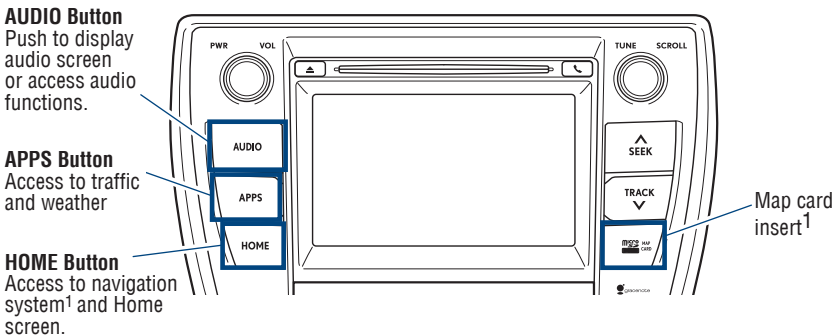

HOME SCREEN - The home screen offers a two and three panel layout. Information and layout will vary depending on selected set up.

NOTE: Concentrating on the road should always be your first priority while driving. Do not use the Entune system if it will distract you.

¹ Refer to the "Navigation System Owner's Manual" and "2017 Entune™ Audio Quick Reference Guide."

FEATURES AND OPERATIONS

Steering wheel controls (Audio & telephone: Bluetooth®)

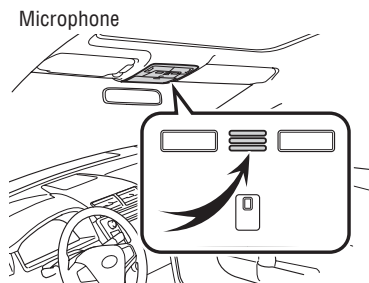
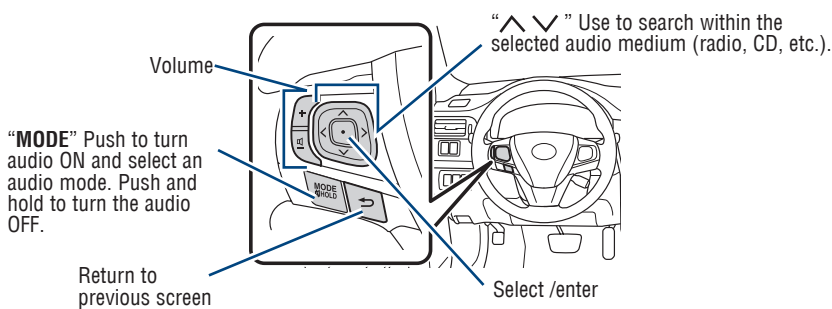
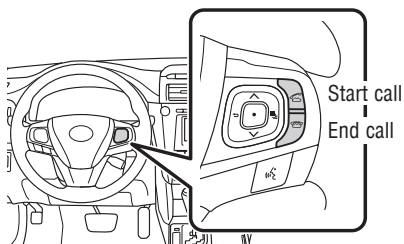

Bluetooth® technology allows dialing or receipt of calls without taking hands from the steering wheel or using a cable to connect the compatible telephone and the system.

Refer to "Connecting Bluetooth®" and "Using a Bluetooth® Phone," Section 5-7,9 in the Owner's Manual, for more information about phone connections and compatibility.

Refer to "Bluetooth® Device Pairing Section" at the end of this booklet, to connect your smart phone to the Entune™ touch screen system.

NOTE: Concentrating on the road should always be your first priority while driving. Do not use the hands-free phone system if it will distract you.

Multi-Information Display (MID)

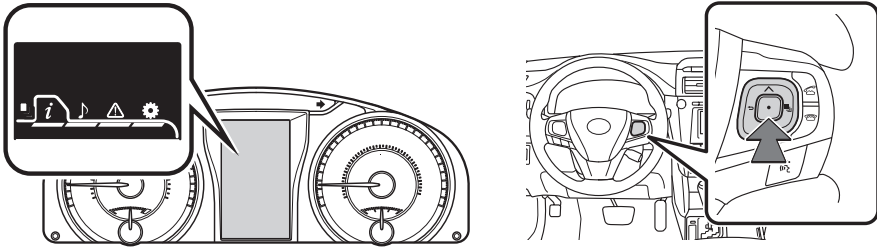

Push “meter control switches” to change information in the following:

- (1) Drive information
- (2) Navigation system linked display
- (3) Audio system linked display
- (4) Dynamic Radar Cruise Control (DRCC)*
- (5) Lane Departure Alert (LDA) status*
- (6) Warning messages
- (7) Settings display
- (8) Tire Pressure Monitoring (warning) System (TPMS)*

* If equipped

Pre-Collision System (PCS) (if equipped)

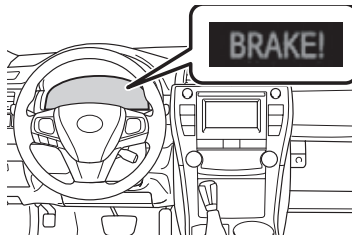

When a high possibility of a frontal collision is detected by the radar sensor, a buzzer sounds and a message urging the driver to take evasive action appears on the Multi-Information Display (MID). If the driver then applies brakes, the system applies greater brake force in relation to how strongly the brake pedal is depressed. If the system determines that a collision is unavoidable, the brakes are automatically applied to reduce the collision speed.

Refer to the Owner's Manual for limitations and more details on this system before attempting to use it.

FEATURES AND OPERATIONS

Lane Departure Alert (LDA)(if equipped)

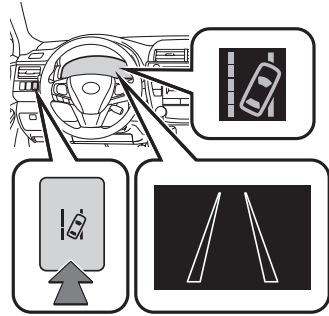
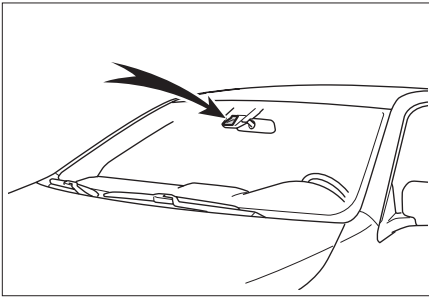

The Lane Departure Alert recognizes the visible lane markers using a camera as a sensor and alerts the driver with beeping and flashing indicators when the vehicle deviates from its lane. Press the LDA switch to activate the system.

Refer to the Owner's Manual for limitations and more details on this system before attempting to use it.

SAFETY AND EMERGENCY FEATURES

Door locks

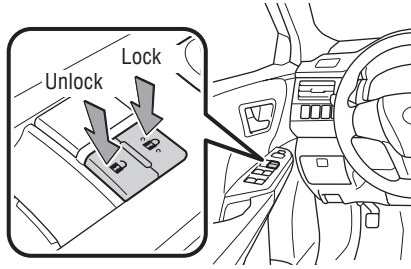

Doors - Child safety locks

Rear door



Moving the lever downward will allow the door to be opened only from the outside.

Seat belts

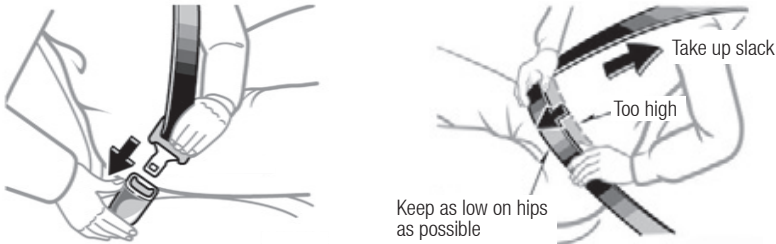

NOTE: If a passenger's seat belt is fully extended, then retracted even slightly, the Automatic Locking Retractor (ALR) will prevent it from being re-extended beyond that point, unless fully retracted again. This feature is used to help hold child restraint systems securely.

To find more information about seat belts, and how to install a child restraint system, refer to the Owner's Manual.

SAFETY AND EMERGENCY FEATURES

Seat belts - Shoulder belt anchor

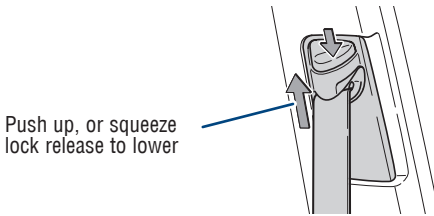

Safety Connect (if equipped)

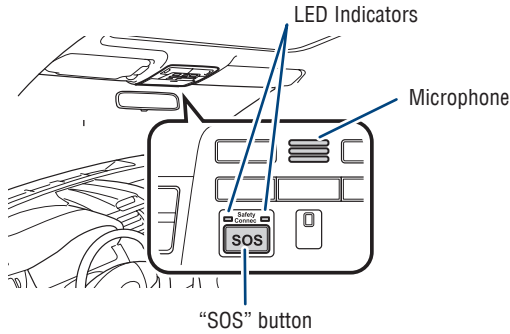

Safety Connect is a subscription-based telematics service that uses Global Positioning System (GPS) data and embedded cellular technology to provide safety and security features to subscribers. Safety Connect is supported by Toyota's designated response center, which operates 24 hours per day, 7 days per week. Services for subscribers include: Automatic collision notification, Stolen vehicle location, Emergency assistance button and Enhanced roadside assistance

Contact your dealer for more information about Safety Connect.

Spare tire & tools

TOOL LOCATION

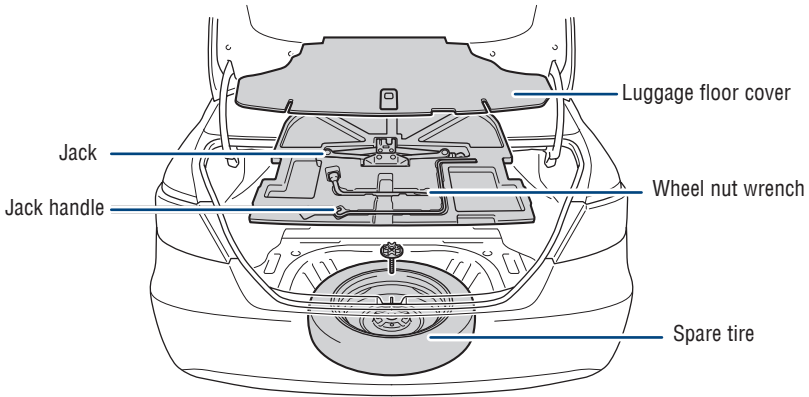

REMOVING THE SPARE TIRE

(1) Remove the tool tray.

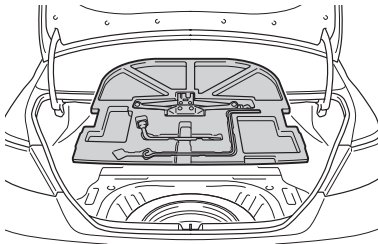

(2) Loosen the center fastener that secures the spare tire.

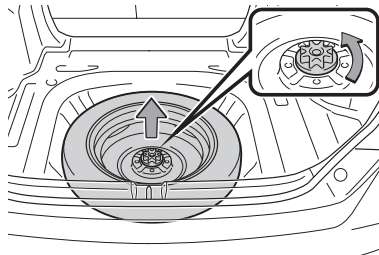

Refer to the Owner's Manual for tire changing and jack positioning procedures.

Trunk-Internal release

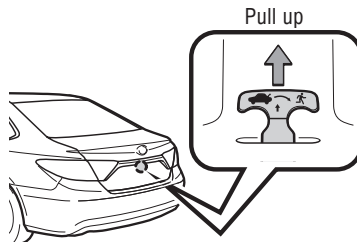

SAFETY AND EMERGENCY FEATURES

Star Safety System™

All new Toyota vehicles come standard with the Star Safety System™, which combines Vehicle Stability Control (VSC), Traction Control (TRAC), Anti-lock Braking System (ABS), Electronic Brake-force Distribution (EBD), Brake Assist (BA) and Smart Stop Technology (SST).

Refer to the Owner's Manual for more details and important information on limitations to these systems.

ENHANCED VEHICLE STABILITY CONTROL (VSC)

Enhanced Vehicle Stability Control provides cooperative control of the ABS, TRAC, VSC and EPS.

Enhanced VSC helps to maintain directional stability when loss of traction occurs during a turn.

TRACTION CONTROL (TRAC)

VSC helps prevent loss of traction during cornering by reducing Hybrid System output, and Traction Control helps maintain traction on loose gravel and wet, icy, or uneven surfaces by applying brake force to the spinning wheel(s).

Toyota's TRAC sensors are activated when one of the drive wheels starts to slip. TRAC limits Hybrid System output and applies the brakes to the spinning wheel. This transfers power to the wheels that still have traction to help keep you on track.

ANTI-LOCK BRAKE SYSTEM (ABS)

ABS helps prevent brakes from locking up by "pulsing" brake pressure to each wheel. This limits brake lockup and helps provide directional control for the current road conditions.

Toyota's ABS sensors detect which wheels are locking up and limits wheel lockup by "pulsing" each wheel's brakes independently. Pulsing releases brake pressure repeatedly for fractions of a second. This helps the tires attain the traction that current road conditions will allow, helping you to stay in directional control.

ELECTRONIC BRAKE FORCE DISTRIBUTION (EBD)

Toyota's ABS technology has Electronic Brake-force Distribution (EBD) to help maintain control and balance when braking. Abrupt stops can cause a vehicle to tilt forward, reducing the braking power of the rear wheels. EBD responds to sudden stops by redistributing brake force to enhance the braking effectiveness of all four wheels.

BRAKE ASSIST (BA)

Brake Assist is designed to detect sudden or "panic" braking, and then add braking pressure to help decrease the vehicle's stopping distance. When there's only a split second to react, Brake Assist can add additional brake pressure more quickly than just the driver alone can.

Smart Stop Technology automatically reduces driving torque when the accelerator and brake pedals are pressed simultaneously under certain conditions.

Floor mat installation

There are two types of Toyota floor mats: carpeted and all-weather. Each vehicle has model-specific floor mats. Installation is easy.

To keep your floor mat properly positioned, follow these steps:

- Only use Toyota floor mats designed for your specific model.
- Use only one floor mat at a time, using the retaining hooks to keep the mat in place.
- Install floor mats right side up.

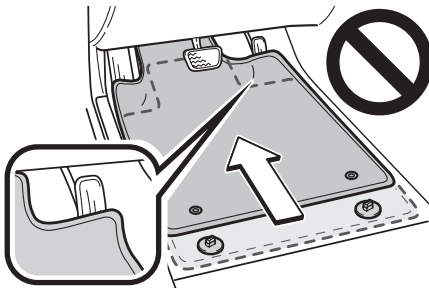
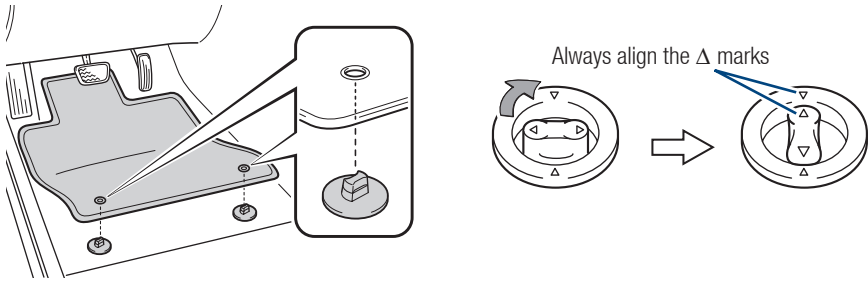

BLUETOOTH® DEVICE PAIRING SECTION

Do not attempt the Bluetooth® Pairing process while driving.

To begin the Bluetooth® Pairing process, press the HOME button on the faceplate of your Toyota Vehicle Entune™ Multimedia Head Unit.¹

Bluetooth® Pairing for Android phone and Entune™ touch screen system

Pairing your phone is the first step in connecting with your Toyota for hands-free calling and for audio streaming via Bluetooth. This pairing process is quick and easy: all Android mobile digital devices have Bluetooth integrated; all you have to do is setup the phone and multimedia system to “talk” to each other and form a connection.²

Initiate Bluetooth® on your Android®

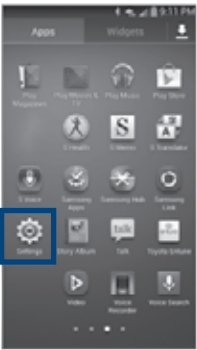

STEP 1
From your **APPS SCREEN**, select **SETTINGS**.

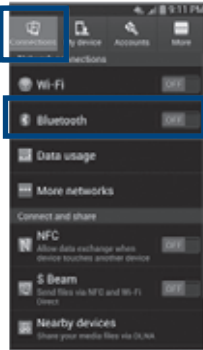

STEP 2
Select **CONNECTIONS** and select **BLUETOOTH**.

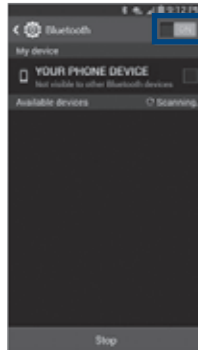

STEP 3
Ensure **BLUETOOTH** is **ON**.

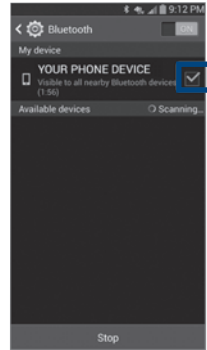

STEP 4
Select **YOUR PHONE DEVICE** to make it discoverable.

Phone will seek out Bluetooth devices while remaining discoverable.



STEP 5
While your Android device is seeking out Bluetooth devices, proceed to your Entune Multimedia Head Unit on your Toyota vehicle.

¹ To determine which head unit is installed in your vehicle, refer to the Audio section in this guide. Entune™ Premium Audio screens are shown in this section. Screens and features may vary by Entune™ system.

² Some Android devices may have slightly different SETTINGS screen layout depending on manufacturer of device and Android OS version.

BLUETOOTH® DEVICE PAIRING

Initiate Bluetooth® on your Entune™ Multimedia Head Unit

Once you have Bluetooth enabled on your phone and ready to pair, you will need to initiate Bluetooth on your Entune head unit. Please follow the instructions below to pair your Bluetooth enabled phone to your Entune system.



STEP 6

On your Toyota Vehicle Entune Multimedia Head Unit, Select **SETUP BUTTON** on the Home Screen.



STEP 7

Select **BLUETOOTH**.

Image shown is a sample image, features may vary.



STEP 8

Select **ADD**, to add your phone device.

For Entune™ Audio System, press the **SETUP BUTTON** on the faceplate to access the Setup Screen.

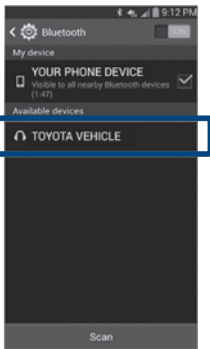

STEP 9

Back on your smartphone, you can now select your **TOYOTA VEHICLE** in Bluetooth Settings.

You may need to enter the provided Bluetooth PIN on your phone.

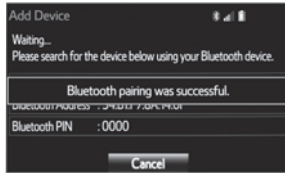

STEP 10

Your smartphone is now paired with Entune.

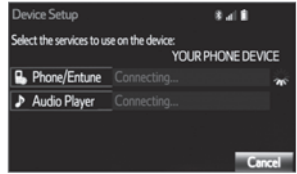

STEP 11

Once paired, Entune will attempt to connect audio and contacts on your phone.

Initiate Bluetooth® on your Entune™ Multimedia Head Unit

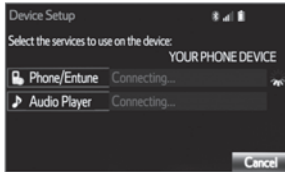
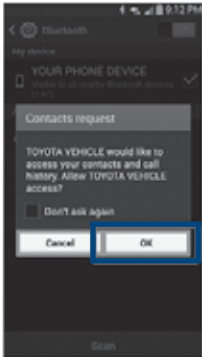

STEP 12

Using your smartphone, you will need to allow Entune access to your messaging and contacts.

It is recommended to check the "Don't ask again" box, so as not to have to press OK every time the phone makes a Bluetooth connection with your Toyota.

STEP 13

A confirmation will appear once your phone has been paired and connected.

Additional Resources

If you're having trouble pairing your phone, Toyota has you covered. You can get more information from the following sources:

Online Pairing Guide:
www.toyota.com/connect

Your Toyota Owner's Manual
Located in the vehicle glovebox

Toyota Customer
Experience Center
(800) 331-4331

Disclosures

This brochure is accurate at the time of print; content subject to change based on periodic multimedia software updates.

1. Concentrating on the road should always be your first priority while driving. Do not use the hands-free phone system if it will distract you.
2. The Bluetooth word mark and logos are registered trademarks owned by Bluetooth SIG, Inc. and any use of such marks by Toyota is under license. A compatible Bluetooth enabled phone must first be paired. Phone performance depends on software, coverage & carrier.
3. Android is a trademark of Google Inc.
4. Apps/services vary by phone/carrier; functionality depends on many factors. Select apps use large amounts of data; you are responsible for charges. Apps & services subject to change. See Toyota.com/entune for details.

Bluetooth® Pairing for iPhone and Entune™ touch screen system

****Do not attempt the Bluetooth® Pairing process while driving.****

Pairing your phone is the first step in connecting with your Toyota for hands-free calling and for audio streaming via Bluetooth. This pairing process is quick and easy: all iPhone mobile digital devices have Bluetooth integrated; all you have to do is setup the phone and multimedia system to “talk” to each other and form a connection.

Initiate Bluetooth® on your iPhone®



STEP 1

From the **HOME SCREEN**, select **SETTINGS**.

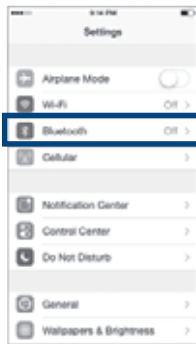

STEP 2

Select **BLUETOOTH**.

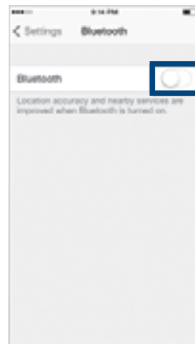

STEP 3

Ensure **BLUETOOTH** is **ON**.

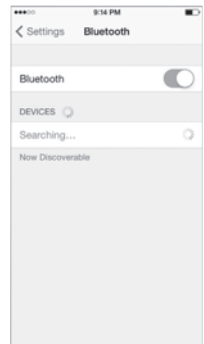

STEP 4

Your iPhone will seek out Bluetooth devices while remaining discoverable.



STEP 5

While your iPhone device is seeking out Bluetooth devices, proceed to your Entune Multimedia Head Unit on your Toyota vehicle.

Initiate Bluetooth® on your Entune™ Multimedia Head Unit

Once you have Bluetooth enabled on your phone and ready to pair, you will need to initiate Bluetooth on your Entune head unit. Please follow the instructions below to pair your Bluetooth enabled phone to your Entune system.



STEP 6

On your Toyota Vehicle Entune Multimedia Head Unit, Select **SETUP BUTTON** on the Home Screen.

For Entune™ Audio System, press the **SETUP BUTTON** on the faceplate to access the Setup Screen.



STEP 7

Select **BLUETOOTH**.

Image shown is a sample image, features may vary.

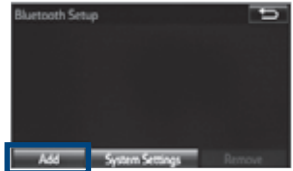

STEP 8

Select **ADD**, to add your phone device.



STEP 9

Back on your smartphone, you can now select your **TOYOTA VEHICLE** in Bluetooth Settings.

You may need to enter the provided Bluetooth PIN on your phone.

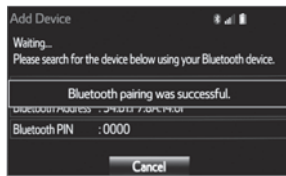

STEP 10

Your smartphone is now paired with Entune.

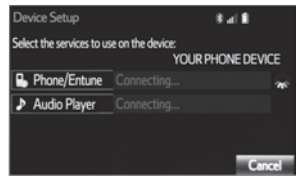

STEP 11

Once paired, Entune will attempt to connect audio and contacts on your phone.

BLUETOOTH® DEVICE PAIRING

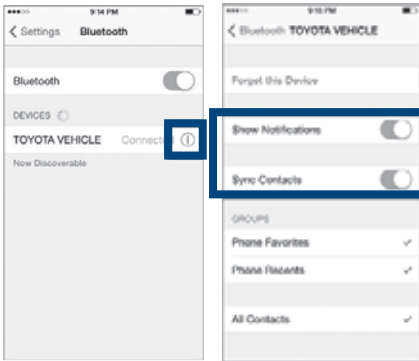

STEP 12

Using your smartphone, you may need to allow Entune access to your messaging and contacts.

Only current iPhone text messages can be viewed on the head unit. iPhone does not allow text message reply.

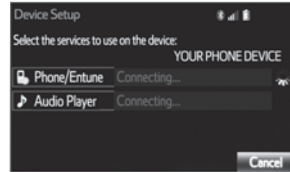

STEP 13

A confirmation will appear once your phone has been paired and connected.

Additional Resources

If you're having trouble pairing your phone, Toyota has you covered. You can get more information from the following sources:

Online Pairing Guide:
www.toyota.com/connect

Your Toyota Owner's Manual
Located in the vehicle glovebox

Toyota Customer
Experience Center
(800) 331-4331

Disclosures

This brochure is accurate at the time of print; content subject to change based on periodic multimedia software updates.

1. Concentrating on the road should always be your first priority while driving. Do not use the hands-free phone system if it will distract you.
2. The Bluetooth word mark and logos are registered trademarks owned by Bluetooth SIG, Inc. and any use of such marks by Toyota is under license. A compatible Bluetooth enabled phone must first be paired. Phone performance depends on software, coverage & carrier.
3. Android is a trademark of Google Inc.
4. Apps/services vary by phone/carrier; functionality depends on many factors. Select apps use large amounts of data; you are responsible for charges. Apps & services subject to change. See Toyota.com/entune for details.

Bluetooth® Pairing for Windows Phone and Entune™ touch screen system

****Do not attempt the Bluetooth® Pairing process while driving.****

Pairing your phone is the first step in connecting with your Toyota for hands-free calling and for audio streaming via Bluetooth. This pairing process is quick and easy: all Windows Phone mobile digital devices have Bluetooth integrated; all you have to do is setup the phone and multimedia system to “talk” to each other and form a connection.

Initiate Bluetooth® on your Windows Phone®

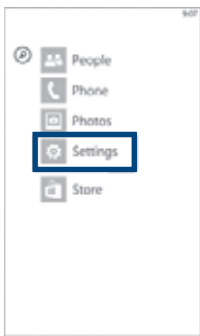

STEP 1

From your APP LIST, select **SETTINGS**.

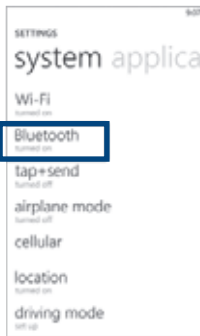

STEP 2

Select **BLUETOOTH**.

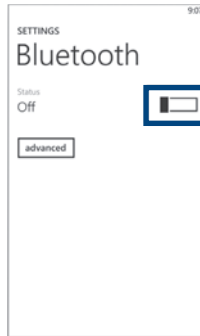

STEP 3

Ensure **BLUETOOTH** is **ON**.



STEP 4

Phone will seek out Bluetooth devices while remaining discoverable.



STEP 5

While your iPhone device is seeking out Bluetooth devices, proceed to your Entune Multimedia Head Unit on your Toyota vehicle.

BLUETOOTH® DEVICE PAIRING

Initiate Bluetooth® on your Entune™ Multimedia Head Unit

Once you have Bluetooth® enabled on your phone and ready to pair, you will need to initiate Bluetooth® on your Entune head unit. Please follow the instructions below to pair your Bluetooth enabled phone to your Entune system.



STEP 6

On your Toyota Vehicle Entune Multimedia Head Unit, Select **SETUP BUTTON** on the Home Screen.



STEP 7

Select **BLUETOOTH**.

Image shown is a sample image, features may vary.

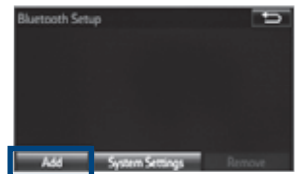

STEP 8

Select **ADD**, to add your phone device.

For Entune™ Audio System, press the **SETUP BUTTON** on the faceplate to access the Setup Screen.



STEP 9

Back on your smartphone, you can now select your **TOYOTA VEHICLE** in Bluetooth Settings.

You may need to enter the provided Bluetooth PIN on your phone.

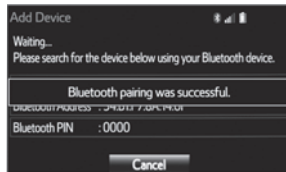

STEP 10

Your smartphone is now paired with Entune.

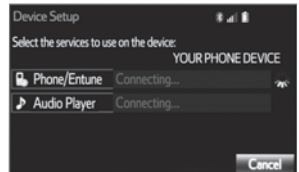

STEP 11

Once paired, Entune will attempt to connect audio and contacts on your phone.

Initiate Bluetooth® on your Entune™ Multimedia Head Unit



STEP 12

Using your smartphone, you may need to allow Entune access to your contacts.

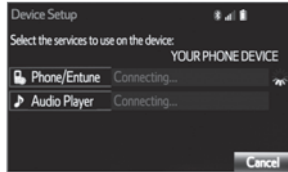

STEP 13

A confirmation will appear that your phone has been paired and connected.

Additional Resources

If you're having trouble pairing your phone, Toyota has you covered. You can get more information from the following sources:

Online Pairing Guide:
www.toyota.com/connect

Your Toyota Owner's Manual
Located in the vehicle glovebox

Toyota Customer
Experience Center
(800) 331-4331

Disclosures

This brochure is accurate at the time of print; content subject to change based on periodic multimedia software updates.

1. Concentrating on the road should always be your first priority while driving. Do not use the hands-free phone system if it will distract you.
2. The Bluetooth word mark and logos are registered trademarks owned by Bluetooth SIG, Inc. and any use of such marks by Toyota is under license. A compatible Bluetooth enabled phone must first be paired. Phone performance depends on software, coverage & carrier.
3. Android is a trademark of Google Inc.
4. Apps/services vary by phone/carrier; functionality depends on many factors. Select apps use large amounts of data; you are responsible for charges. Apps & services subject to change. See Toyota.com/entune for details.

NOTES

NOTES



CUSTOMER EXPERIENCE CENTER
1-800-331-4331

